

First International Conference organized within the framework of  
PolyUrbanWaters Research and Project Network (BMBF 2019-2025)

# POLYURBAN WATERS

**Polycentric management of urban  
waters in fast-growing cities and  
peri-urban areas in Southeast Asia**

Arlene Christy D. Lusterio, TAO-Pilipinas Inc.

Global Perspectives on strategic planning tools and methods for  
sustainable futures

***• Planning future cities: active participation of  
communities engaging local governments. Experiences  
from the Philippines.***

**24-25<sup>th</sup>  
March 2021**

**Online /  
Berlin / Kratie /  
Sleman / Vientiane**

# Presentation Outline

1. Context: TAO-Pilipinas and its Work
2. Case Studies
  - Project Objectives
  - Methods/Approaches
  - Results
3. Difficulties/Challenges
4. Lessons Learned



# 1. TAO-Pilipinas and its work in the Philippines

- Women-led non-profit, non-government organization of primarily architects, planners, engineers.
- Envisions sustainable human settlements development
- Advocate for participatory planning, design, development and management
- Works directly with communities threatened by eviction and/or affected by disasters

MAP SOURCE:

[https://www.google.com/search?q=philippine+map+with+region+LidvAnRP8Yz65zdGS4Xcuw:1615881239606&tbm=isch&source=xe9DbAjBM%252C\\_xoiRbd6oTMzEgM%252C\\_&vet=1&usg=AI4\\_-kSE4WvdNZbGc\\_QW40sT93e3WgYoZQ&sa=X&ved=2ahUKEwjqqWzLByMQ9QF6BAgdEAE&biw=1707&bih=821#imgsrc=oBTioXiXcLPWGSgUxM](https://www.google.com/search?q=philippine+map+with+region+LidvAnRP8Yz65zdGS4Xcuw:1615881239606&tbm=isch&source=xe9DbAjBM%252C_xoiRbd6oTMzEgM%252C_&vet=1&usg=AI4_-kSE4WvdNZbGc_QW40sT93e3WgYoZQ&sa=X&ved=2ahUKEwjqqWzLByMQ9QF6BAgdEAE&biw=1707&bih=821#imgsrc=oBTioXiXcLPWGSgUxM)

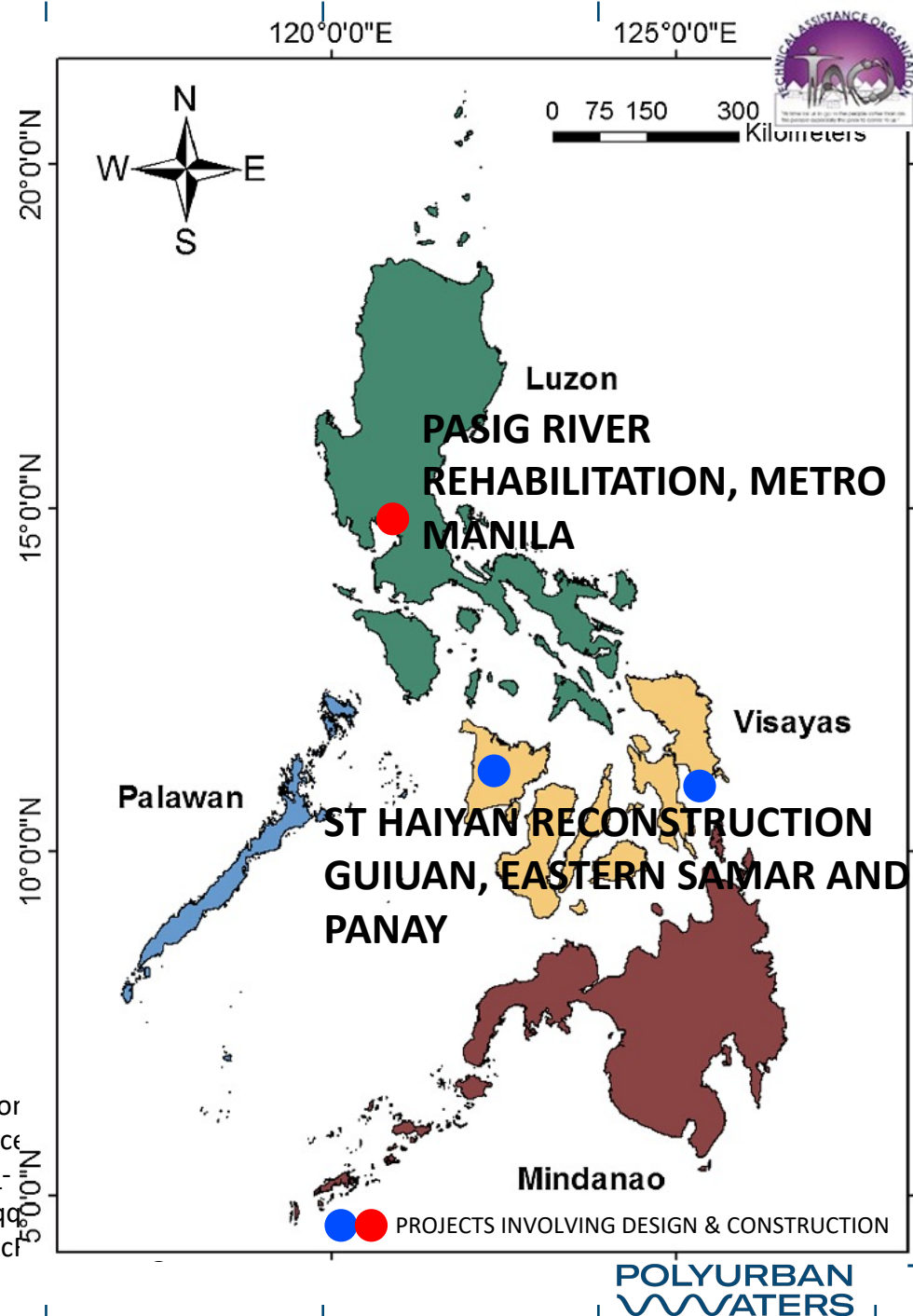

## 2. Case Study: Pasig River Rehabilitation (2001- 2004)

### Background

- 27 kilometers long, average of 91m wide and 0.5 to 5.5m deep
- Traverses 5 cities (Manila, Makati, Mandaluyong, San Juan, Pasig) and one municipality (Taytay)
- Occupied by about 20,000 informal settler families
- In 1990 Pasig River was declared biologically dead due to very high Pollution level. The government implemented a Rehabilitation Master Plan to revert the water quality to Class C.

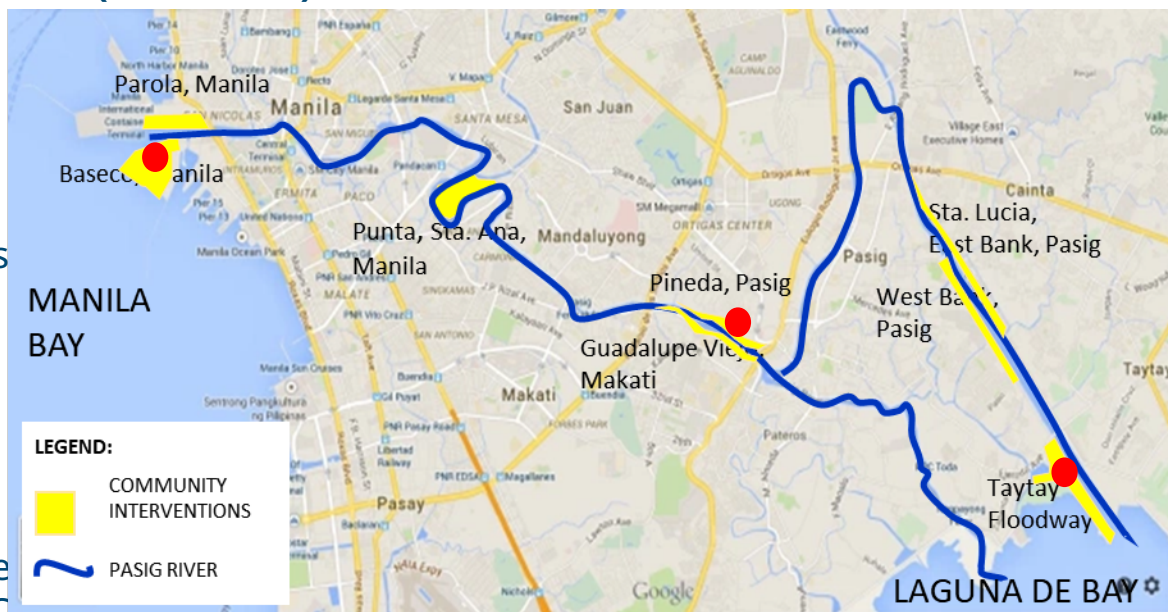

Source of Basemap: <https://codexpo.esy.wordpress.com/2015/01/26/a-road-and-a-river-in-metro-manila/>

Goal: Improve environmental management of the Pasig River basin within Metro Manila particularly for wastewater management

### Project Objective

Assist organized communities along Pasig River formulate their people's plan.

A people's plan is the plan formulated by the beneficiary-association, which shall contain a site development, that conforms to the CLUP of the local government unit under whose jurisdiction the project site is supposed to be located including community health, sanitation and security plans, as well as non-physical development components such as self-help housing cooperative, livelihood, self-help development, capability building and a system of allocation of socialized housing units that promote and protect the welfare of the elderly, persons with disability and children. (



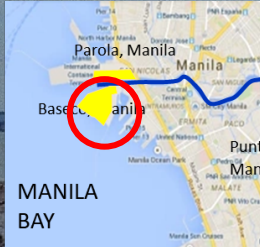

## BASECO – (BATAAN SHIPPING AND ENGINEERING COMPANY) COMPOUND, MANILA (2001)

54 hectares informally reclaimed site, designated as urban renewal area (URA)

### • Methods/Approaches

#### 1. Site Investigation – Initial visit and consultation

- site condition,
- quality of housing stock, density
- Existing facilities and services
- Access and circulation





# Lecture about planning and design laws/ standards

## Participatory Planning and Design

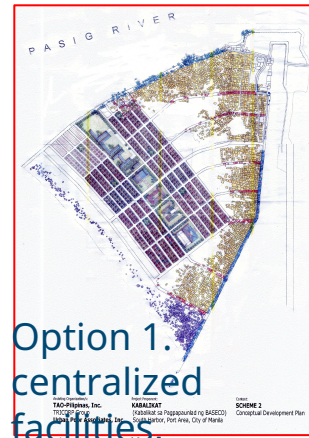

Option 1.  
centralized  
facilities,  
rowhouse type  
houses

**Results**

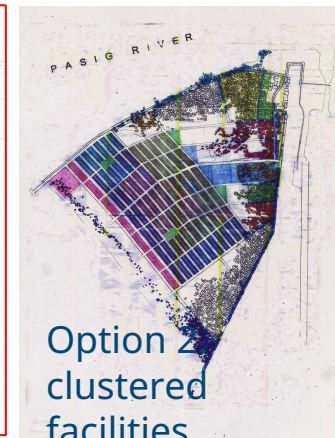

Option 2.  
clustered  
facilities,  
rowhouse and  
duplex type  
houses

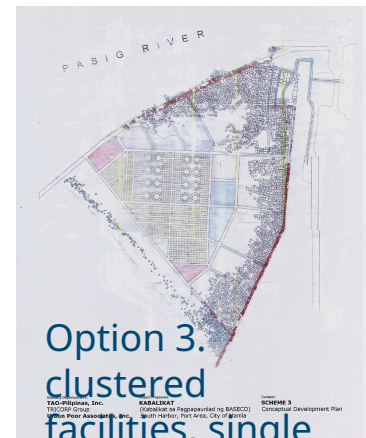

Option 3.  
clustered  
facilities, single  
detached houses

Consolidated ideas for development. 3 Schemes were prepared. A final scheme was selected and presented to the City Mayor as their **people's plan**.

People were allowed to stay and their preferred development option was

**POLYURBAN WATERS**



# PINEDA, PASIG CITY

## Principle of minimum dislocation maximum retention

1. Designated as an Environmental Protection Area (EPA)
2. Clearance of 10-m easement along the banks of the river
3. Structure mapping
4. Block consultations with affected households to identify solutions and come up with agreements.

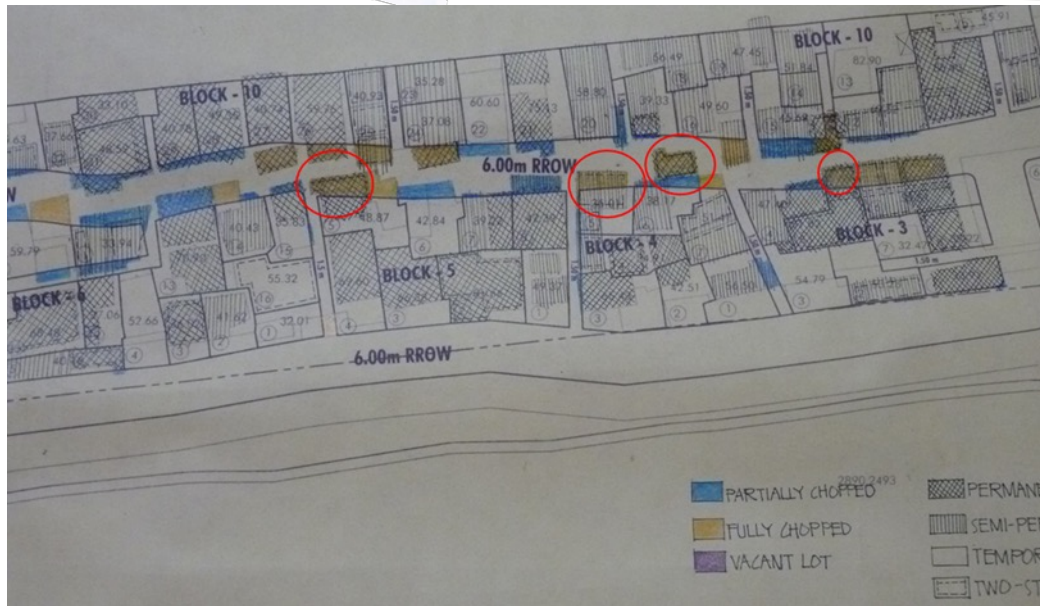

Scheme was presented to the city Mayor of Pasig. The scheme was accepted with revisions:

- Make the internal road 6m
- Add two basketball courts







# POST- TS KETSANA: MANGGAHAN FLOODWAY 2009

Informal settlements along mandatory easements along floodway

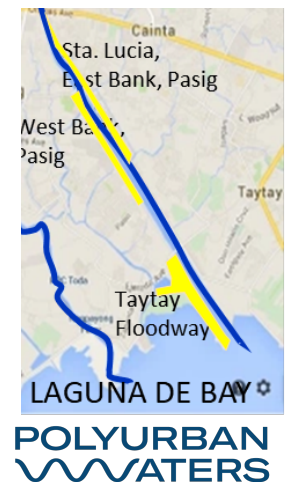

POLYURBAN  
WATERS



# DAMAYAN SA FLOODWAY, TAYTAY,

RIZAL



Things to remember in  
Designing a house

## MGA DAPAT TANDAAN SA PAGDISENYO NG BAHAY

1. MINIMUM NA LAKI NG KWARTO: 2M X 3M
2. MINIMUM NA LAKI NG CR: 0.90M X 1.2M
3. MINIMUM NA LAPAD NG HAGDAN: 0.70M
4. KAILANGANG MAY BINTANA ANG CR.
5. KAILANGAN MAY BINTANA BAWAT KWARTO.
6. MAXIMUM NA LAPAD NG TERRACE NA NAKAHARAP SA MALIIT NA KALSADA: 0.60M

Validation Workshop:  
Two-Storey Prototype House Design  
Damayan, Sitio Lumang Ilog, Taytay  
16 February 2012

Minimum size of  
bedroom: 2m x 3m  
Minimum size of toilet:  
0.90m x 1.20m  
Minimum width of  
stairs: 0.70m  
Windows for Toilet  
Windows for bedroom  
Maximum width of  
terrace facing a minor

## 2. Capacity-building on planning and design





# DAMAYAN SA FLOODWAY, TAYTAY, RIZAL

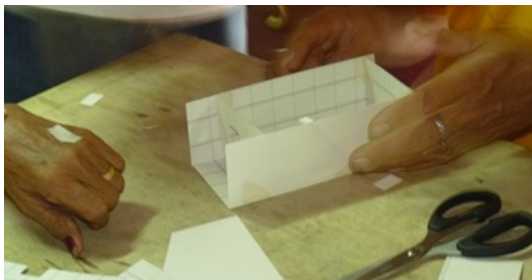
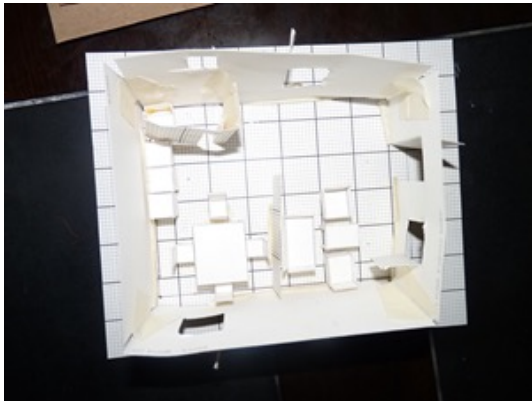



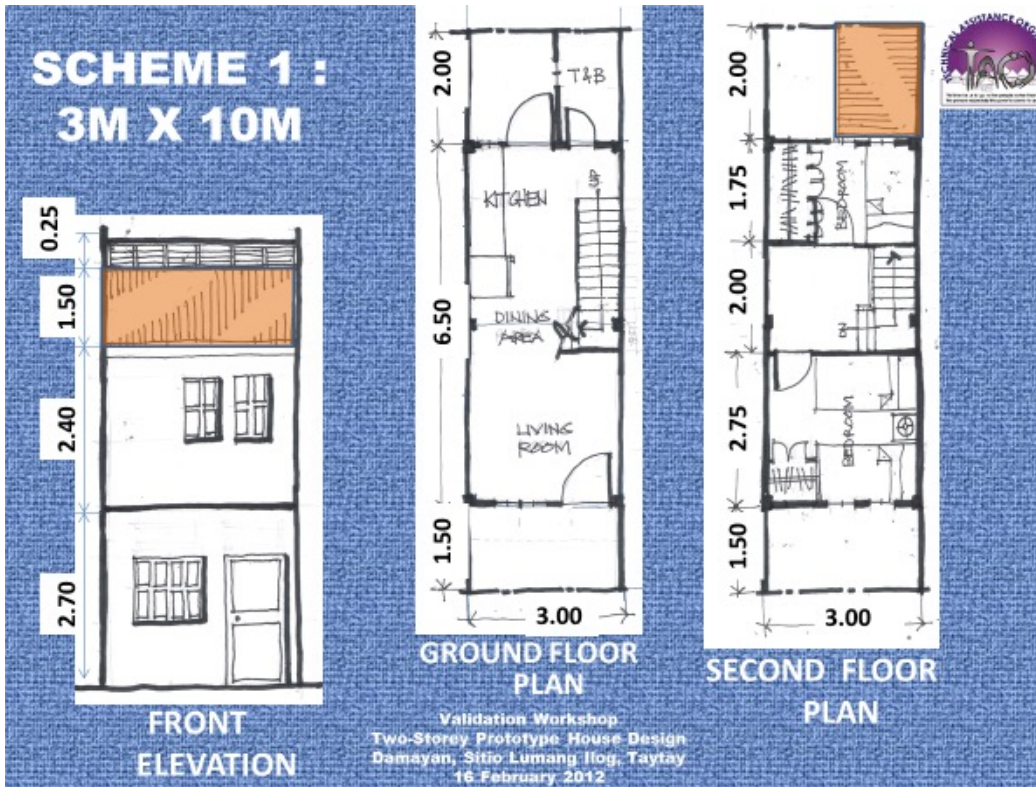
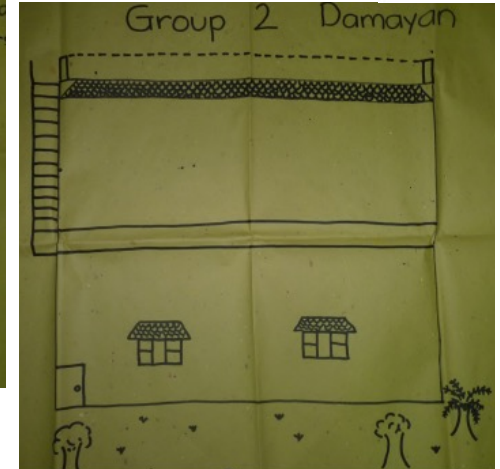



# Difficulties/Challenges

- Limited information/ data about the site and the users
- Limited resources and technology
- Massive informal settlement that needs to be consulted
- Participatory process is tedious and consumes a lot of time.
- There were cases where what the people want may not be the right solution:
  - ☐ Continue occupying the embankment of the floodway in West Bank, Pasig
  - ☐ Use of Floating Foundation for Model house in Taytay Floodway

## Lessons Learned

- Work with what is available (data/information, resources)
- Be clear and honest about the limitations
- Technical professionals need social skills to communicate and work with the poor.
- Technical Plans are powerful tools for negotiations with government.
- People's participation in planning and design is empowering. It gives voice to and ownership of the solution by the community.



Maraming Salamat po.  
Thank you very much.